

plan

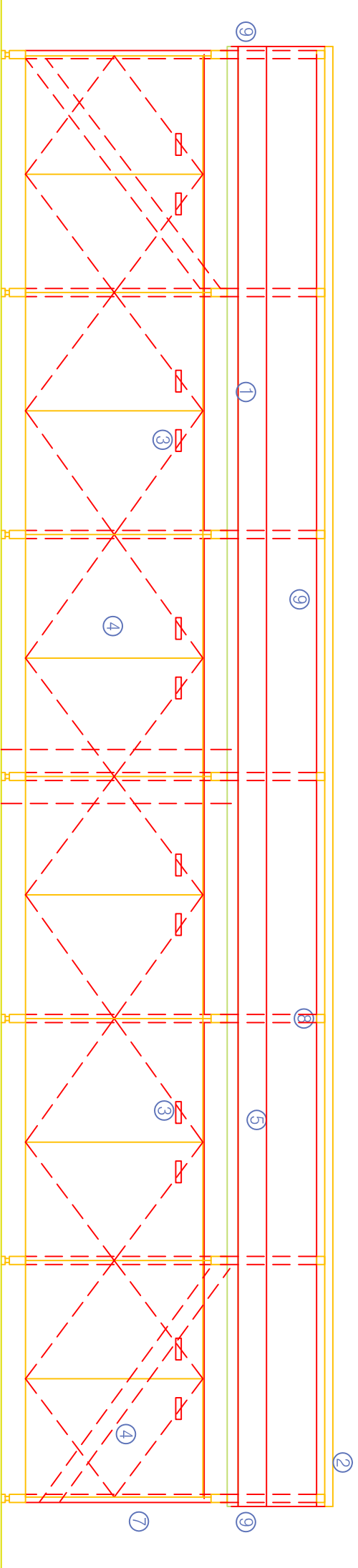

elevation a-a

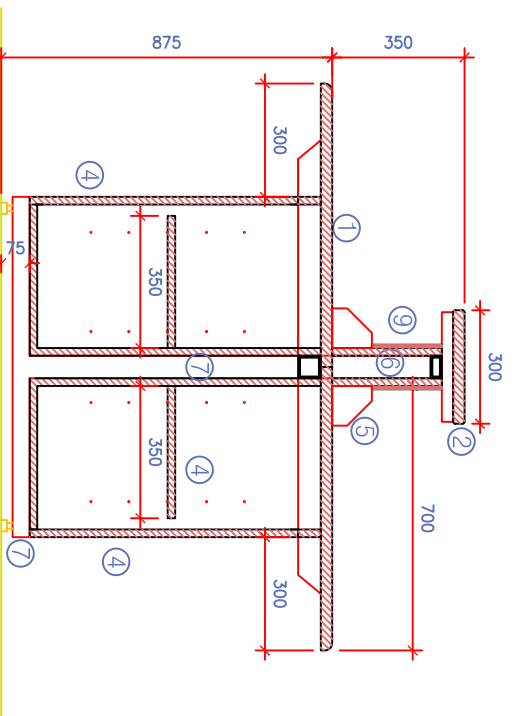

section b-b

**Legend:**

1. 30 mm thick MDF worktop with decorative high pressure laminate
2. 30 mm thick MDF small tools/instrument shelf with decorative high pressure laminate
3. Ironmongery: Stainless steel recessed press handle, reverse fixed through door. Self-closing hinges and high quality cylinder type lock.
4. 18 mm thick MDF cupboard doors and carcass with decorative high pressure laminate on steel/support brackets
5. Dado trunking with metal finish.
6. 18 mm MDF mounting board sealed to specification.
7. Metal Frame:  
60 x 30 mm MS frame and legs with cross bracing as shown.  
All with powder coated finish to selected RAL colour on adjustable feet. 60 x 60 mm SHS to support worktop full length
8. 30 x 30 mm MS support for small tools/instrument shelf with end caps with powder coated finish to selected RAL colour.
9. 9 mm thick demountable plywood fixed to MDF. Plywood cover also to gable ends of unit
10. Allow space for cable rise

**Minimum Standards for materials and finishes:**

Core material for worktops, doors and carcasses:  
Dry Fibre Board (MDF) to I.S. EN 622-5 Class E1 formaldehyde content tested to EN 120.  
Moisture resistant board to I.S. EN 622-5 MDF-H, class E1 formaldehyde content tested to EN 120.

Core materials to be finished with plastic laminates to comply with I.S. EN 438, grade HGS/HGP (including vertical panels, shelves and doors).  
Balancing laminate to be used in all cases.

Edges of all laminated panels (if not postformed) to be finished with solid colour laminate (2 mm thickness), PVC or hardwood edges to seal all edges.

Solid timber to comply with IS EN 942, Class J10.  
FSC/PEFC chain of custody certification required for all timber and timber products, including MDF.

Metal frames:  
Generally 60 x 30 mm mild steel frame with welded end caps and adjustable feet. Epoxy powder coated to selected RAL colour.

Ironmongery:  
Stainless steel door handles, reversed fixed through doors. High quality stainless steel or nickel plated self-closing hinges (180°) and high quality cylinder style lock on masterkey system to suit the school's requirements.

Hardwood plinth size to be coordinated with skirting height in rooms.

**Note:**

Alternative materials and finishes of equal or higher specification and performance are permitted.  
Drawings to be read in conjunction with specification.

<b>ELECTRONIC WORKSTATION - EWS</b>		SCALE:	1:20
		DRG No:	045
REVISION:	CHECKED BY :	DATE:	JUNE '10
REMARKS:	PREPARED BY:		

